

Firebox – Instructions for Use

Contents

Assembly Instructions	3 - 5
Before using the firebox	6
Parts included in delivery	6
Intended use	6
For your safety	6 - 8
Warning symbols	6
General safety instructions	7
Safety instructions.....	7 - 9
Assembly	10
Unpacking	10
Assembling the firebox.....	10
Setting up the firebox	10
Operation	10 - 11
Maintenance and cleaning	11 - 12
Disposal	12
Technical data	12
Warranty	13
Service	13
Distributor	13

Assembly Instructions

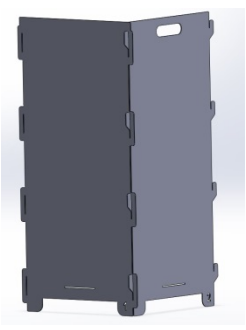
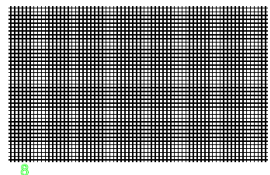
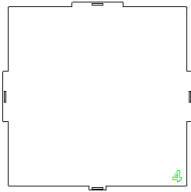
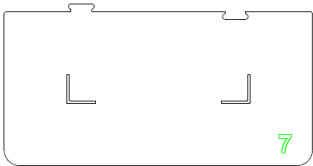
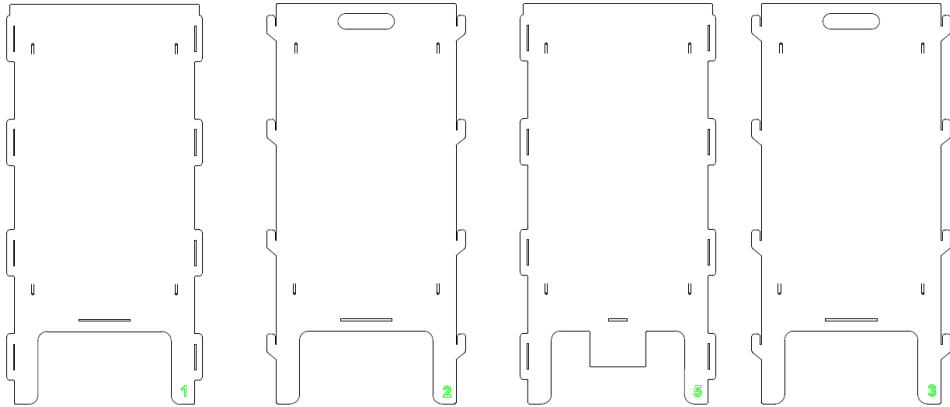

Step 1: Fit sides 1 and 2 together using slot-in connection system.

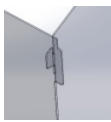

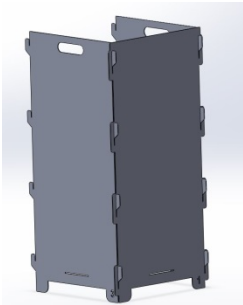

Step 2: Connect sides 1 and 2 with side 3.

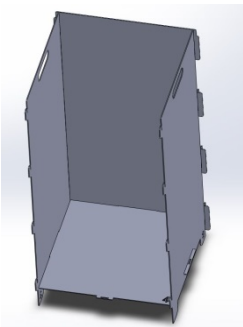

Step 3: Insert the base (4) into the slit in sides 1, 2 and 3.

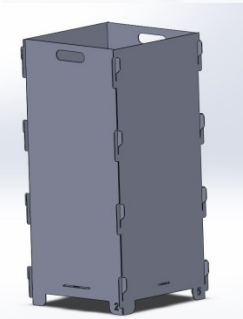

Step 4: Connect side 5 with sides 1-4.

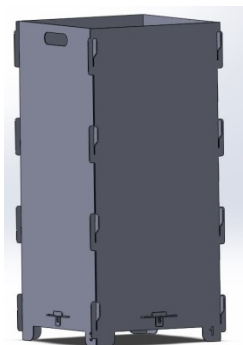

Step 5: Insert the splint (6) into the base (4)

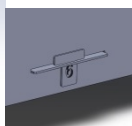

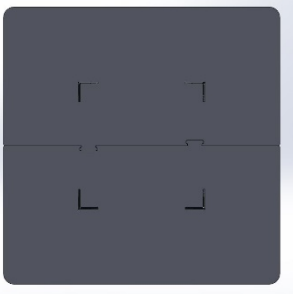

Step 6: Assemble the ground plate (7).

Step 7:

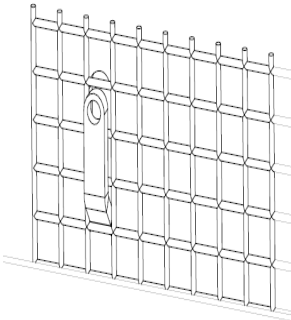

During assembly of the firebox, fix the spark arrester grills (8) to the corresponding side sections (1, 2, 3, 5). The side elements are equipped with hooks for this purpose. The hooks are tabs that have been cut into the metal of the side section and then bent inwards into the firebox. They therefore project on the inside. The tip of each hook is provided with a perforation. The purpose of this is to make it easier and safer to bend the hooks inwards, for example with the aid of a screwdriver. There are four hooks for each spark arrester grill, positioned so as to match each corner of the grill. The grill should be slotted onto all four brackets at the same time; it will then be securely but detachably fixed to the side section.

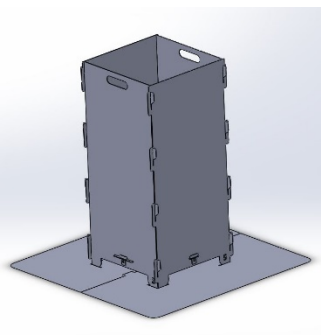

Step 8:

Fit the firebox into the rectangular cutouts and place it on a fireproof, heat-resistant, undersurface. The firebox is now ready for use.

Before using the firebox

After unpacking the firebox and before each use, always inspect it for damage.

Should you notice any damage, do not use the firebox. Instead, please inform our Customer Service.

When using the firebox, always note and comply with any specific laws and regulations that apply in your country.



Read through the safety instructions and the instructions for use carefully before taking the firebox into operation. Only then will you be sure of being able to make use of all the functions safely and reliably.

Keep these instructions for use in a safe place and also pass them on to any future user of the firebox.

Parts included in delivery

A Base No. 4 (1x)

B Side section

No. 1,2,3,5 (4x)

C Splint No. 6

(4x)

D Ground plate No. 4 (2x)

E Spark arrester grill No. 8 (4x)

Please check that the delivery is complete and undamaged. If any item is missing or damaged, please contact our Customer Service.

Intended use

The device is intended for use as a firebox (brazier) and must be positioned on a level, load-bearing and fireproof undersurface (e.g. concrete etc.).

It is suitable for outdoor use only and is intended exclusively for private use.

The article must only be used in the manner described in these instructions for use. Any other use will be deemed improper and may result in damage to property or even injury to persons.

The manufacturer may not be held liable for any damage or injury caused through improper use.

For your safety

Explanation of warning symbols

Caution: High Risk!



Failure to heed the warning may result in injury or death.

Caution: Medium Risk!



Failure to heed the warning may result in damage to property.

Caution: Low Risk!



Matters that should be paid attention to in connection With use of the device.

GENERAL SAFETY INSTRUCTIONS – must always be followed during use of the firebox

- **Never use in enclosed spaces!**
- **CAUTION! Never use spirits (denatured alcohol) or gasoline for lighting or reigniting!**
- **All firelighters used must be in conformity with EN 1860-3!**
- **CAUTION! This device can become very hot and must not be moved during operation!**
- **CAUTION! Keep children and animals well away from the firebox!**
- **CAUTION! This device can become very hot and must not be moved during operation!**
- **Never leave the firebox unattended while a fire is burning!**

Safety instructions

Caution: Fire risk!



Smoldering wood and the body of the firebox become very hot during operation and can cause fires.

General safety instructions

- Always have a fire extinguisher and First Aid Kit near at hand and be prepared for accidents or the outbreak of a fire.
- To ensure safe handling of this device, the user must have read and understood the Instructions for Use before using it for the first time.
- Note and comply with all the safety instructions! Failure to do so can result in danger to yourself and others.
- Keep all instructions for use and safety instructions handy in case of need for future reference.

- Keep children at a safe distance. Store the firebox out of reach of children and unauthorized persons.
- All parts of the device must be assembled correctly to ensure safe and proper functioning.
- Alterations, unapproved modifications and the use of non-approved parts is prohibited.

Operation/Location

- Always comply with the national and international safety, health and occupational regulations in force at any time.
- The device may only be taken into use if an inspection has revealed no sign of defects. If any part of the device is faulty, it is essential that it be replaced before the device is used again.
- The immediate surroundings must be free of all easily flammable or explosive substances.
- If it is intended to position the firebox on wood tiles, it is essential that stone slabs or such like be placed between the firebox and the wood.
- The device must not be used by persons below the age of 18 or users who are not properly familiar with use of the device.
- The device must not be used by persons who are unable operate it safely and with due care due to deficiencies in their physical, mental or sensory faculties.
- Always operate the device with care and only if you are in a fit state to do so. Operating it when tired or sick or under the influence of alcohol, medication or drugs must be seen as an act of irresponsibility as you will not be able to use it safely.

Storage and transport

- Always store the device in a dry place.
- Store the device in a frost-free location.
- Protect the device from damage during transport.

Special instructions

- Only use the firebox outdoors, never in enclosed spaces.
- The firebox may be set up indoors as a decorative element only. Operation indoors is not permitted.
- Never use the firebox under an overhanging roof.
- Safe operation of the firebox is only ensured if it is positioned on a firm, level and adequately load-bearing surface.
- Before operation of the firebox, ensure it is positioned in a safe and level location that is as wind-sheltered as possible.
- As firelighting aids, use only dry firelighters or special BBQ lighter fluid in conformity with EN 1860-3 standard. Please also note the manufacturer's remarks.
- Never use fluids such as gasoline, turpentine, denatured alcohol etc. as a lighting or reigniting aid. These substances ignite explosively and are in some cases toxic. Instead, use dry lighters or a chimney starter.
- Never pour lighting fluid or place charcoal/wood soaked in lighting fluid onto charcoal/wood that is already hot or warm.
- Children or animals may only be allowed near the firebox if under supervision. Special care must be taken when lighting the firebox!
- Because of the intense heat, the firebox may become warped!
- Always ensure a safety distance of at least 3 meters (10 feet) from any flammable materials.
- The firebox will become very hot and must not be moved when in operation.
- Do not remove ash until it has cooled completely. Never put hot ashes into the domestic waste – risk of fire!
- Do not clean the firebox until it has cooled completely.
- When putting more fuel on the fire, always wear fireproof gloves (e.g. BBQ gloves).
- Make sure to wear suitable clothing. Long, loose sleeves can easily catch fire!
- Wear sturdy, closed shoes. Sandals offer no protection against burning embers!
- Never leave open fires or smoldering embers unattended. They pose a risk of fire and injury!
- As a precaution, always have a bucket of sand near at hand to put out a fire.
- Put any remaining embers and ashes into a fireproof metal container and fill it up to the top with water. Leave the embers and water in the container for 24 hours before disposing of them.
- Use only untreated, ready-for-burning softwood or hardwood in the firebox. (Do not use pellets made from either kind of wood).
- Never use the firebox as a barbecue.
- Have regard to your neighbors; avoid causing a nuisance through smoke or smells or by putting neighbors' property at risk.
- The firebox must not be used as a waste incinerator, and no unsuitable or unrecommended materials should be used as fuel. Never use liquid fuels.

Caution! Risk of carbon monoxide poisoning! Never use in enclosed spaces, but always outdoors only.

Caution! Make sure to comply with national and local regulations, e.g. relating to permits, operation, safety clearances, etc.

- **The device is liable to rust!**
- **CAUTION! This device will become very hot and must not be moved when in operation!**

Assembly Unpacking

Caution *Hazardous for children!*



When playing, children can become caught in the packing/wrapping materials and are at risk of suffocation.

- Never allow children to play with the packing/wrapping materials.
 - Take care to prevent children from putting any small assembly parts in their mouths as they can easily swallow and choke on them.
-
- Unpack all parts of the device and check them for completeness.

Assembling the firebox

Note:

Assemble the firebox as shown. All the splints must be fitted on the outside of the firebox.

Caution! Risk of injury from sharp edges!



Sheet metal objects can have sharp edges. Therefore, always handle them with care.

Setting up the firebox

Caution: Risk of damage



- Each time you plan to use the firebox, check the splints for a tight fit. If need be, push all the splints once more firmly into place to ensure the firebox is securely assembled and safe.
-
- Before use, make sure the firebox is positioned on a firm, level surface outdoors.

Operation

Caution: Risk of burns!



- During operation, the firebox and the fuel inside it will become very hot, and any contact with them can result in extremely severe burns. Therefore, always wear fireproof gloves (e.g. barbecue gloves in accordance with PPE Regulation/Directive (Category II) and appropriate clothing.
- Keep an adequate distance away from hot objects as any contact can result in extremely severe burns.
 - Make sure not to wear clothing with loose-fitting sleeves.

Caution: Risk of burns!



Never use fluids such as gasoline, turpentine, denatured alcohol etc. as a lighting or reigniting aid. These substances ignite explosively and are in some cases toxic. Instead, use dry lighters.

- Never pour lighter fluid, or place charcoal/wood soaked in lighter fluid, onto charcoal/wood that is already hot or warm.

 - As firelighting aids, use only dry lighters or special BBQ lighter fluid in conformity with EN 1860-3.
1. Create a pyramid out of small sticks of wood.
 2. Insert dry lighters into the pyramid.
 3. Ignite the dry lighters.
 4. Once the sticks are well alight, start adding pieces of wood that become gradually larger.

Caution: Risk of burns!



Always take care that the fire does not become too big.

Never leave an open fire or glowing embers unattended.

Caution: Risk of injury!



Botched repairs can result in the device no longer functioning safely and becoming a source of hazard to yourself and others and to your surroundings.

Maintenance and cleaning

Your firebox is made from high-quality materials. To clean and maintain the surfaces, please take note of the following:

Caution: Risk of burns!



Allow the firebox to cool down completely before cleaning it.

- Do not tip out the ashes until all the fuel has burned up and the fire is completely dead.

Caution: Hazard to health!



Never use paint removers or thinners for removing stains.

Caution: Risk of damage!



Never use powerful or abrasive solvents or scouring pads as these will attack the surfaces and leave scratches.

- After use, leave the fuel to burn out completely. This will help to reduce the subsequent cleaning effort.
- **The formation of rust on the device is normal.**
- Remove the cold ashes. **It is very important to remove the ashes from the firebox before any moisture can combine with the cold ash. Ash contains salts, and, when damp, will corrode the interior surfaces of the firebox.**
- Remove any loose deposits with a damp sponge.
- For drying, use a soft, clean cloth. Avoid rubbing the surfaces to dry them as this can cause scratching.

- In general, clean the inside and outside surfaces with warm, soapy water.
- To protect the device and keep it dry, cover it with a tarpaulin.
- Store the firebox in a dry, well-ventilated location.

Disposal



The outer packaging is of cardboard.



The firebox must not be disposed of as normal household waste. Instead, take it to an authorized disposal firm or a public collection facility for special waste. Take note of and comply with the regulations in force at the time of disposal. If unsure, contact your local waste disposal service provider.

Technical data

Product: Firebox,
rectangular

Dimensions cm: 78x38x38

Warranty

You have purchased a high-quality firebox. Under the terms of our warranty, we warrant all parts of your firebox as free of material and manufacturing defects for a period of 24 (twenty-four) months from the date of purchase on condition that it is subject to normal, leisure-related and non-commercial use only during that time.

This warranty does not cover failure or user difficulties resulting from willful damage, misuse, modification, incorrect use, careless handling, normal wear and tear, incorrect assembly or poor maintenance.

Service

In the case of technical questions, please contact our Service Department. This product has been manufactured and packaged with care. Should it nevertheless give grounds for complaint, our personnel will be pleased to help you further.

In case of service questions, you can contact us at the email address (Customer Service) shown below.

Subject to technical modifications / Printing errors reserved.

Distributor